



19676

Telegraph Trail

LANGLEY, BC

FOR LEASE - UNIT 2

Casey Bell*
Executive Vice President
Casey.Bell@am.jll.com
+1 604 998 6014

* Personal Real Estate Corporation

Keegan Matheson
Associate
keegan.matheson@am.jll.com
+1 778 991 9406

OPPORTUNITY

The rare opportunity to lease a distribution building in Port Kells.

LOCATION

Port Kells situated in arguably the most sought-after industrial hub in Metro Vancouver. The area is instantly accessible from Highway 1 via both 192nd Street and 200th Street interchanges. Golden Ears Way flows east-west along the Fraser River, connecting the area to both the Golden Ears Bridge and the South Fraser Perimeter Road.



ZONING
M-2 Medium Impact Industrial



OCCUPANCY
April 1st2023



LEASE RATE
\$23.50 PSF



OPERATING COST
\$4.45 PSF
Estimate

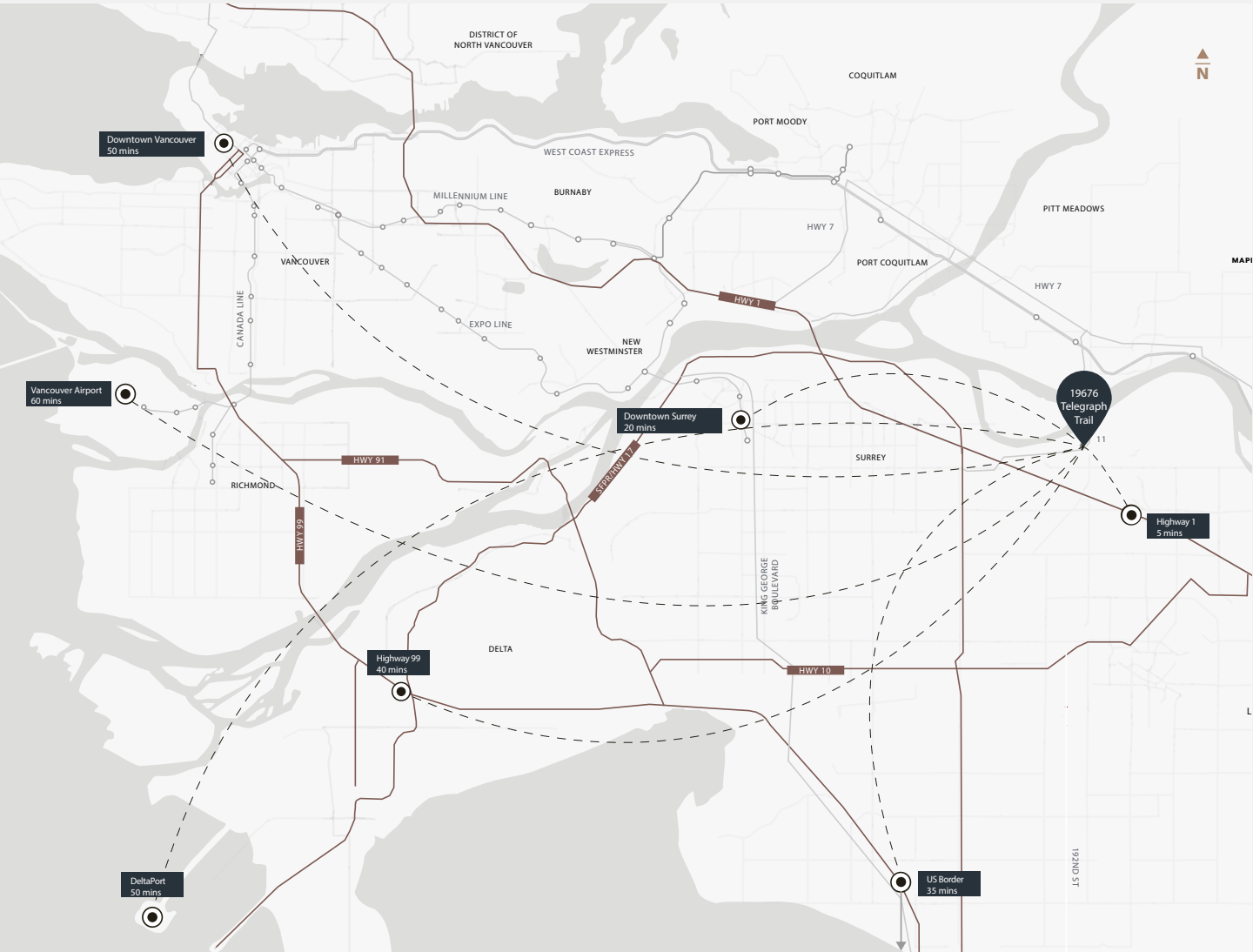

CONSTRUCTION
Concrete tilt-up



CEILING HEIGHT
24' clear



INTERIOR WALLS
Painted interior walls
for greater illumination



SPRINKLERS
Fully sprinklered



LIGHTING
High efficiency LED
fixtures



**AIR CONTIONED
OFFICE**



RECIRCULATION FANS
Ceiling fans located near
loading doors



HEATERS
Gas-fired unit
heaters



Warehouse	23,026 SF
Office	2,420 SF
Total	25,446 SF
Loading	5 Dock and 1 Grade

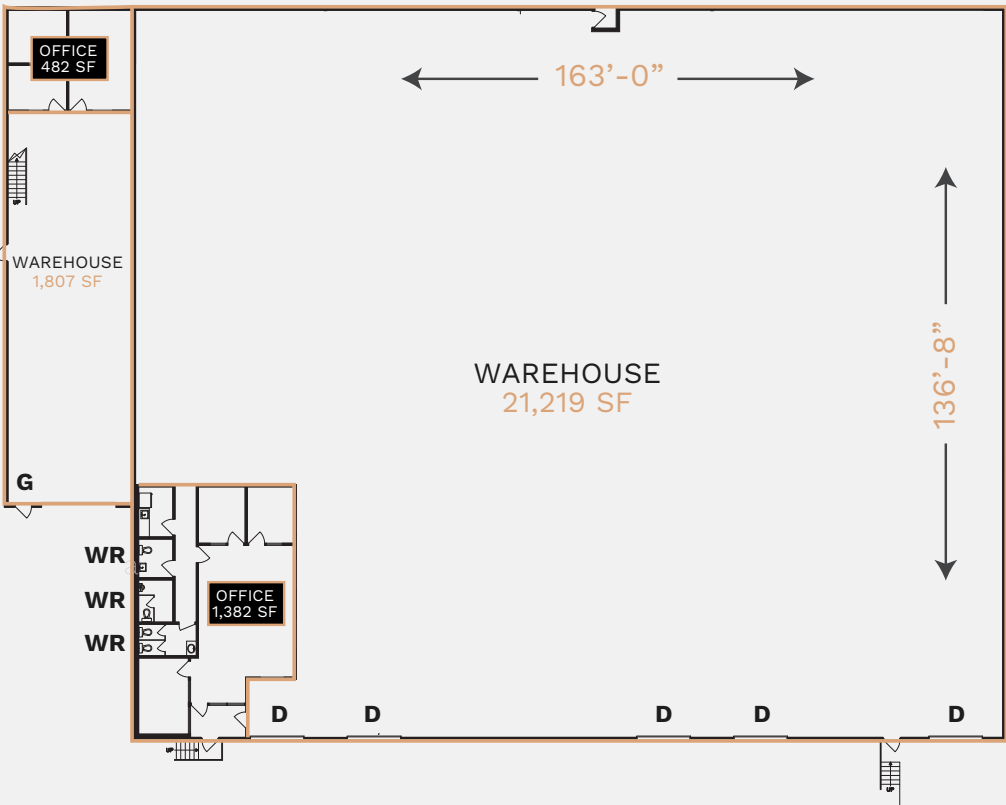

Casey Bell*
Executive Vice President
Casey.Bell@am.jll.com
+1 604 998 6014

* Personal Real Estate Corporation

Keegan Matheson
Associate
keegan.matheson@am.jll.com
+1 778 991 9406



jll.ca
510 West Georgia Street, Suite 2150
Vancouver, BC V6B 0M3
Jones Lang LaSalle Real Estate Services, Inc.

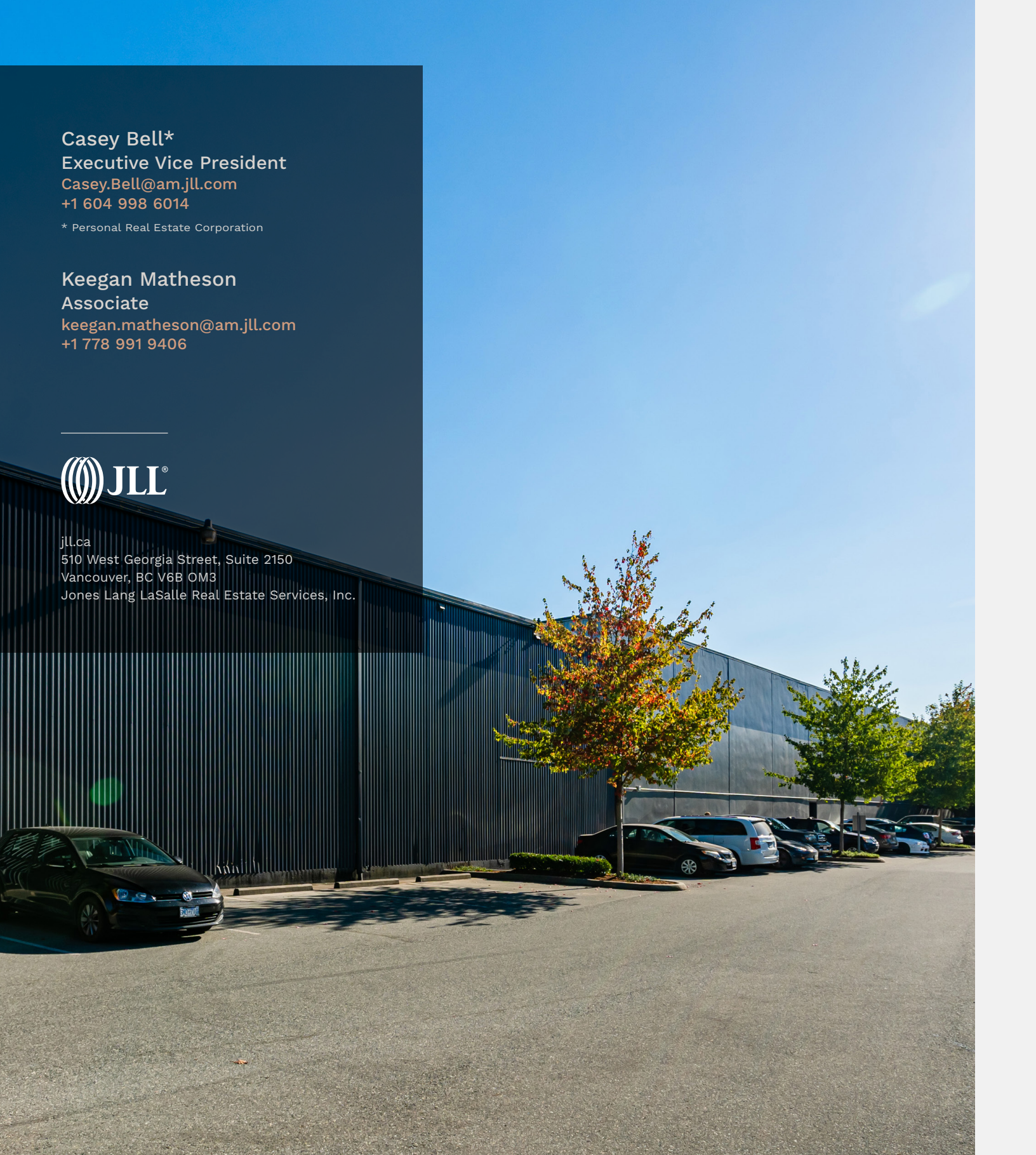

© 2022 Jones Lang LaSalle IP, Inc. All rights reserved. Information set out herein (the "Information") has not been verified by Jones Lang LaSalle Real Estate Services, Inc., Brokerage and any and all of its real estate agents/staff, and to all other divisions of the company (collectively "JLL"). JLL does not represent, warrant or guarantee the accuracy, correctness and completeness of the Information. Given the limitations of the investigations, inquiries and verification that JLL have undertaken, the reliability of this Information must be treated with a suitable degree of caution and neither JLL or any of their affiliates accept any liability or responsibility for the accuracy or completeness of the information contained herein and no reliance should be placed on the information contained in this document. JLL does not accept or assume any responsibility or liability, direct or consequential, for the Information or the recipient's reliance upon the Information. The recipient of the Information should take such steps as the recipient may deem necessary to verify the Information prior to placing any reliance upon the Information. The Information may change and any property described in the Information may be withdrawn from the market at any time without notice or obligation to the recipient from JLL.