

FOR LEASE

1538

Cliveden Ave.

DELTA British Columbia

Unit 128/138/148 and Unit 248/268



Jonathan Jassebi*
Vice President
+1 604 998 6141
jonathan.jassebi@jll.com
*Personal Real Estate Corporation



Bruno Fiorvento*
Executive Vice President
+1 604 998 6006
bruno.fiorvento@jll.com
*Personal Real Estate Corporation



LOCATION

The subject property is located on Cliveden Avenue on the western side of Annacis Island in Delta, BC. Annacis Island is the first choice for many distribution and industrial users and is home to many high profile corporations. The area is considered to be one of the lower mainland’s premier industrial parks due to its central location and easy accessibility to all of Metro Vancouver via Highway 99 and Highway 91 as well as the South Fraser Perimeter Road (SFPR) interchange at the south end of the Alex Fraser Bridge.

 **ASKING LEASE RATE:**
\$21.25 PSF Net

 **ADDITIONAL RENT:**
\$5.56 PSF



ANNACIS ISLAND

1538

Cliveden Ave.
DELTA British Columbia

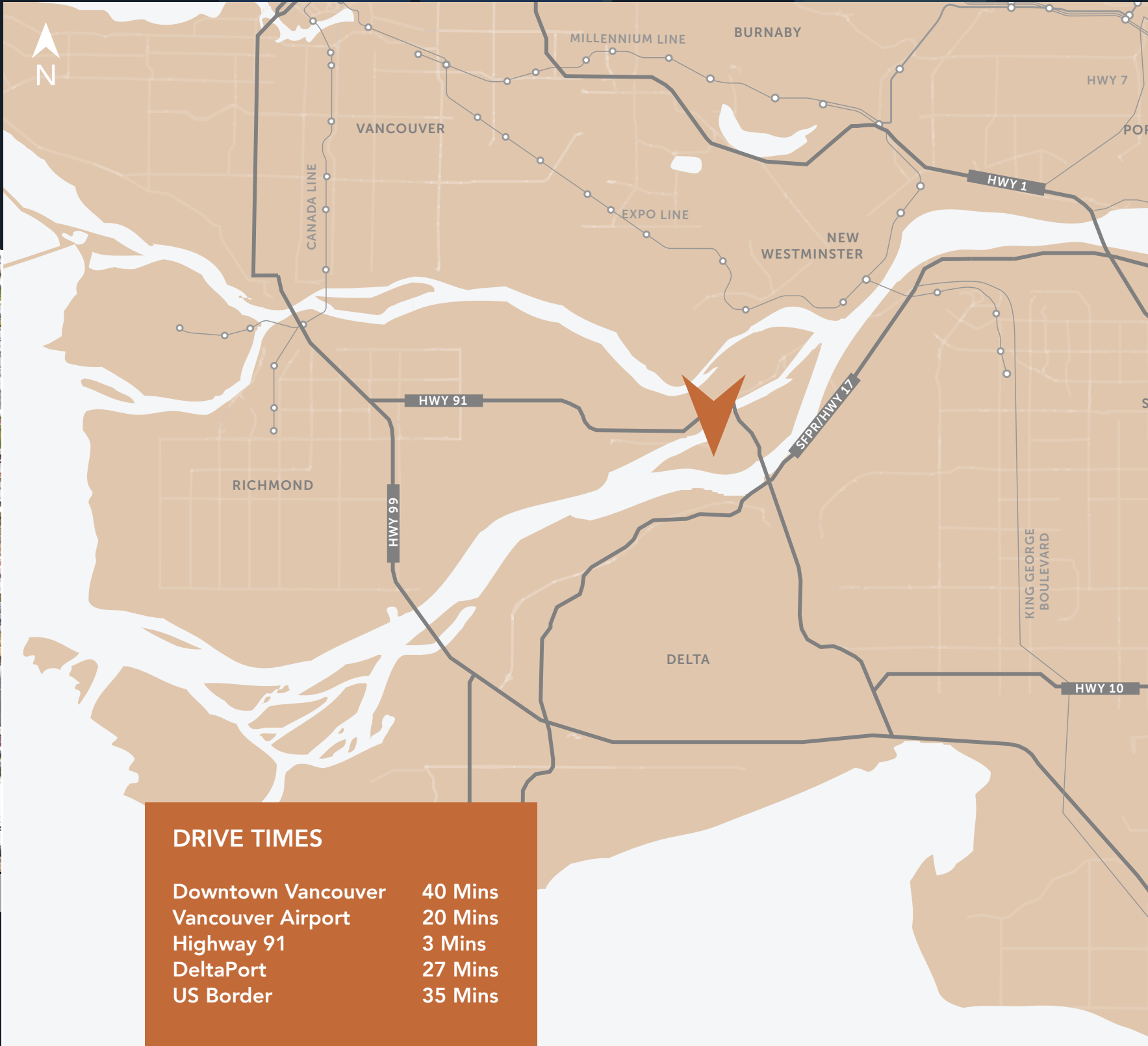

DRIVE TIMES	
Downtown Vancouver	40 Mins
Vancouver Airport	20 Mins
Highway 91	3 Mins
DeltaPort	27 Mins
US Border	35 Mins

Property Overview

FLOOR PLAN

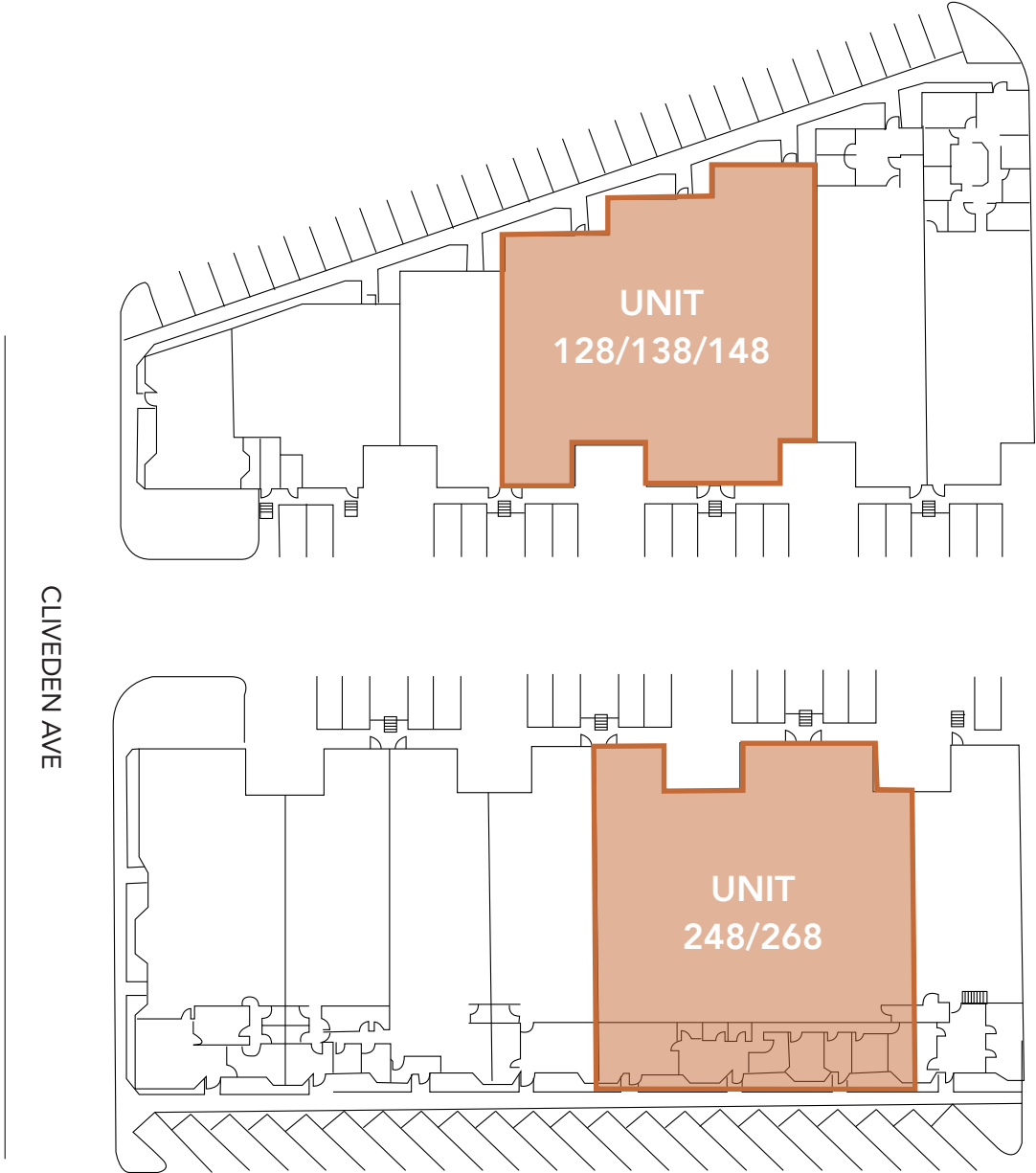

UNIT 128/138/148

Warehouse	7,588 SF
Office Area	1,897 SF
Total Area	9,485 SF

UNIT 248/268

Warehouse	8,320 SF
Office Area	2,516 SF
Total Area	10,836 SF



OVERVIEW

Available Units	Unit 128/138/148 - Unit 248/268
Availability	Within 60 days
Zoning	I-2 (Medium Impact Industrial)

FEATURES

- ▶ 22' clear ceiling height
- ▶ Six (6) dock loading doors
- ▶ Concrete tilt-up construction
- ▶ Fully sprinklered
- ▶ Overhead gas fired heating units in the warehouse
- ▶ 500 lbs per square foot floor loads
- ▶ Three phase electrical service
- ▶ Ample parking and truck maneuvering room



1538

Cliveden Ave.

DELTA British Columbia

Unit 128/138/148 and Unit 248/268



JONATHAN JASSEBI*

Vice President

+1 604 998 6141

jonathan.jassebi@jll.com

*Personal Real Estate Corporation

BRUNO FIORVENTO*

Executive Vice President

+1 604 998 6006

bruno.fiorvento@jll.com

*Personal Real Estate Corporation