

# For lease



## Unit 203 669 Ridley Place

Delta, British Columbia



**Jonathan Jassebi\***  
Vice President  
+1 604 998 6141  
[jonathan.jassebi@jll.com](mailto:jonathan.jassebi@jll.com)  
\*Personal Real Estate Corporation



**Mike Thompson\***  
Executive Vice President  
+1 604 809 5836  
[mike.thompson@jll.com](mailto:mike.thompson@jll.com)  
\*Personal Real Estate Corporation

**8,864 SF**  
Warehouse and Office Space  
with 3 Dock Doors



# Floor Plan

Unit 203

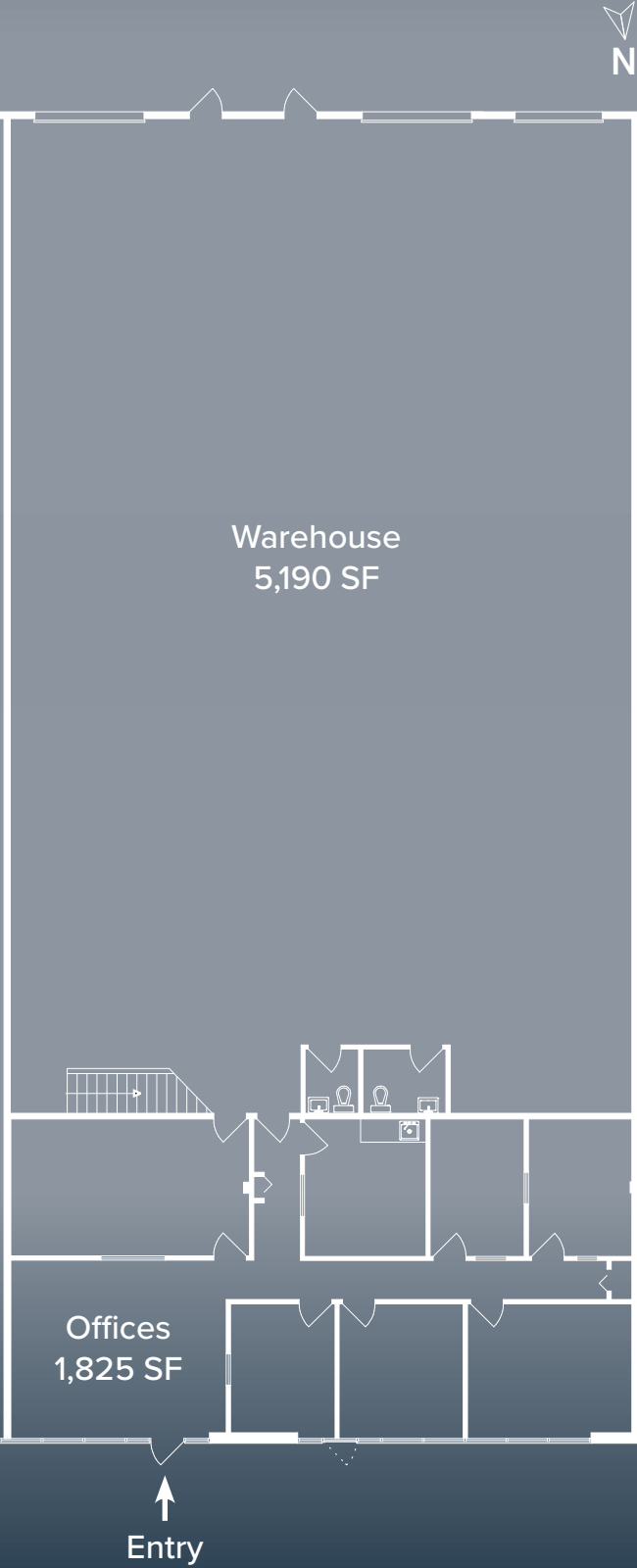

## Available Area:

Warehouse: 5,190 SF  
Offices: 1,825 SF  
Mezzanine: 1,849 SF

## Total Area: 8,864 SF

\*All measurements are approximate and must be verified by the Tenant.

## Zoning:

I-2 Heavy Industrial  
Zoning allows for manufacturing, distribution, assembly, storage, warehousing and most other industrial uses.

## Basic Rent:

\$22.95 PSF

## Additional Rent:

\$4.69 PSF + 5% management fee

## Availability:

April 1st, 2024

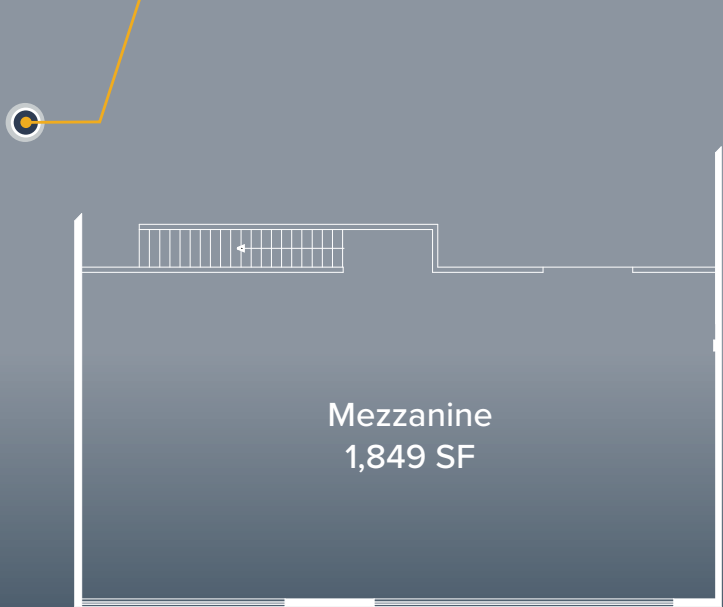

# Property Features



Three (3) Dock



24' Clear ceiling height



Fully finished office areas



Modern building with river views



Energy efficient lighting



Abundant parking



Tenant focused landlord



Heavy 3-phase power

# Location

The property offers excellent access being strategically located in Annacis Business Park. Located in the centre of the Lower Mainland, Annacis Island is considered a premier distribution centre due to its location and accessibility to all municipalities. Highway 91 and Highway 99 provide easy access to all Greater Vancouver regions and southwards to the USA.

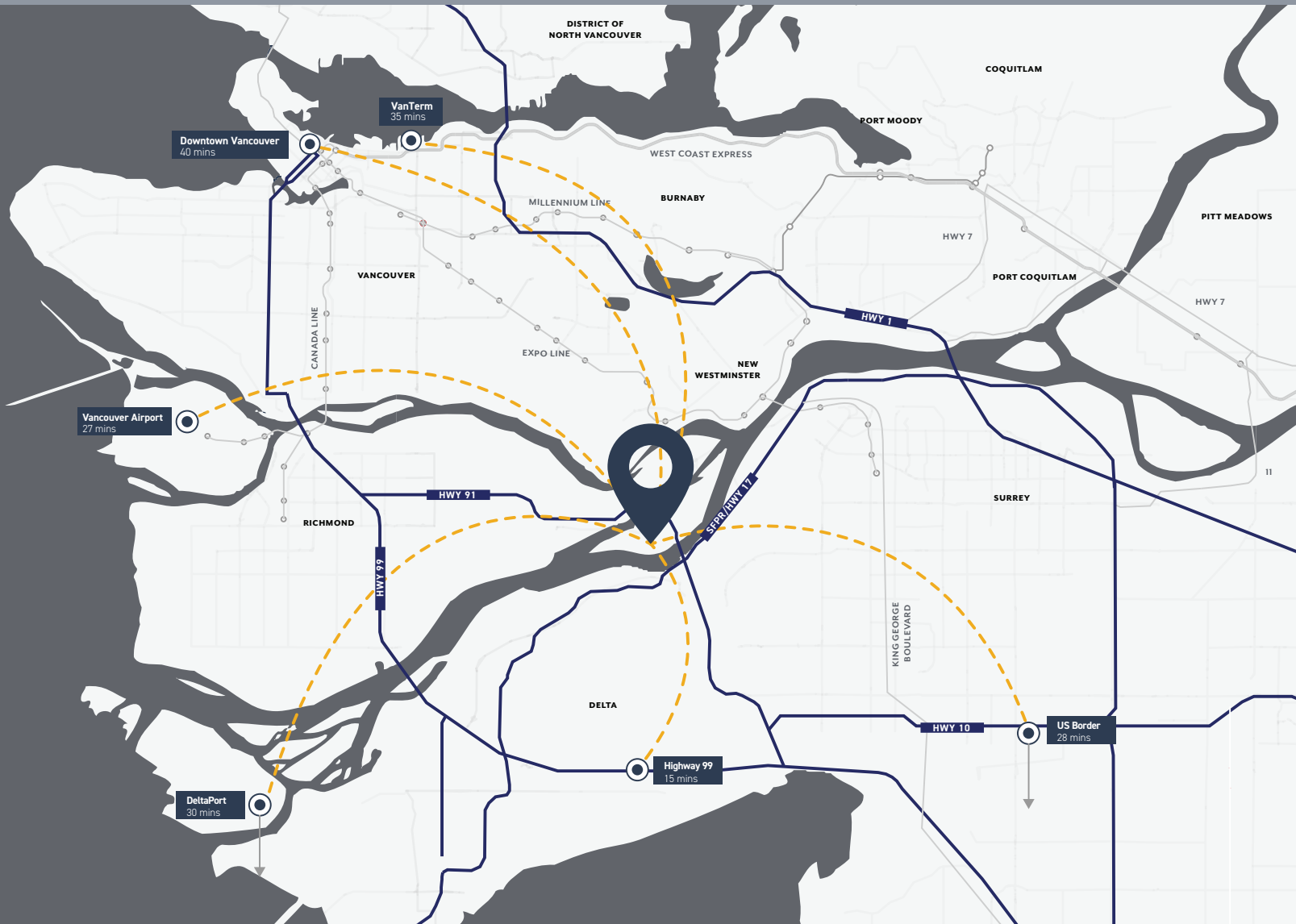

**Jonathan Jassebi\***  
Vice President  
+1 604 998 6141  
[jonathan.jassebi@jll.com](mailto:jonathan.jassebi@jll.com)

\* Personal Real Estate Corporation

**Mike Thompson\***  
Executive Vice President  
+1 604 998 6036  
[mike.thompson@jll.com](mailto:mike.thompson@jll.com)

\* Personal Real Estate Corporation



[jll.ca](http://jll.ca)  
510 West Georgia Street, Suite 2150  
Vancouver, BC V6B 0M3  
Jones Lang LaSalle Real Estate Services, Inc.

© 2024 Jones Lang LaSalle IP, Inc. All rights reserved. Information set out herein (the "Information") has not been verified by Jones Lang LaSalle Real Estate Services, Inc., Brokerage and any and all of its real estate agents/staff, and to all other divisions of the company (collectively "JLL"). JLL does not represent, warrant or guarantee the accuracy, correctness and completeness of the Information. Given the limitations of the investigations, inquiries and verification that JLL have undertaken, the reliability of this Information must be treated with a suitable degree of caution and neither JLL or any of their affiliates accept any liability or responsibility for the accuracy or completeness of the information contained herein and no reliance should be placed on the information contained in this document. JLL does not accept or assume any responsibility or liability, direct or consequential, for the Information or the recipient's reliance upon the Information. The recipient of the Information should take such steps as the recipient may deem necessary to verify the Information prior to placing any reliance upon the Information. The Information may change and any property described in the Information may be withdrawn from the market at any time without notice or obligation to the recipient from JLL.