

# 669

RIDLEY PLACE  
DELTA, BC

UNIT 105-106

**8,970 SF**

WAREHOUSE & OFFICE SPACE WITH  
3 DOCK DOORS & 1 GRADE DOOR

UNIT 208

**6,035 SF**

WAREHOUSE & OFFICE SPACE  
WITH 2 DOCK DOORS &  
**BONUS MEZZANINE SPACE**

FOR LEASE



# Highlights

- LEASE RATE**  
**\$18.50 PSF**
- ADDITIONAL RENT**  
**\$5.54 PSF**  
**+5% management fee**
- AVAILABLE**  
**Unit 105-106: September 1, 2026**  
**Unit 208: Immediately**
- CEILING HEIGHT**  
**24'**
- LOADING**  
**Unit 105-106: 3 dock, 1 grade door**  
**Unit 208: 2 dock doors**
- POWER**  
**Heavy 3-phase**
- LIGHTING**  
**Energy efficient lighting**
- OFFICE AREAS**  
**Fully finished**
- PARKING**  
**Abundant parking**
- BUILDING**  
**Modern building with river views**
- LANDLORD**  
**Tenant focused landlord**



## Floor Plan

Unit 105-106

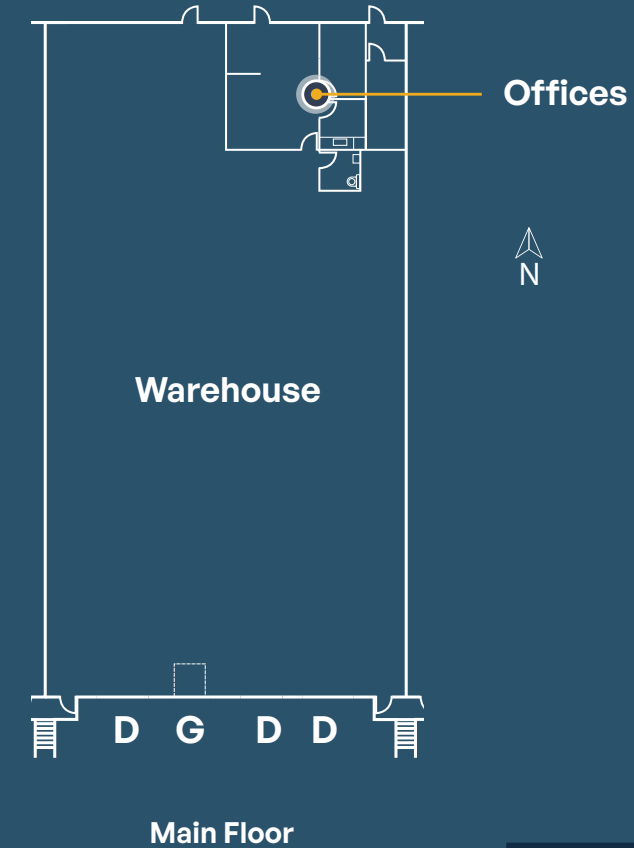

**Warehouse**  
**8,225 SF**  
**Main Floor Office**  
**745 SF**  
**Rentable Area**  
**8,970 SF**

## Floor Plan

Unit 208

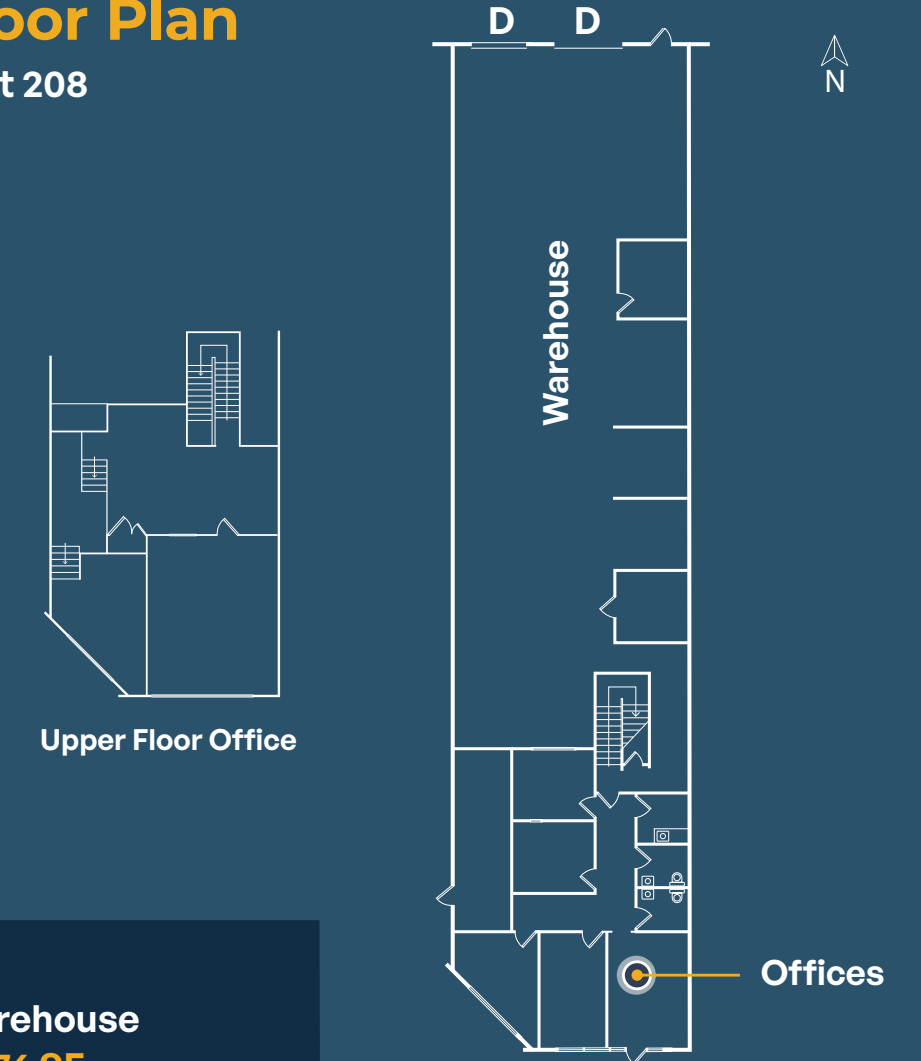

**Warehouse**  
**3,576 SF**  
**Main Floor Office**  
**1,324 SF**  
**Upper Floor Office**  
**1,113 SF**  
**Bonus Mezzanine**  
**424 SF**  
**Rentable Area**  
**6,035 SF**



**Zoning**

**I-2 Heavy Industrial**

Zoning allows for manufacturing, distribution, assembly, storage, warehousing and most other industrial uses.

\* All measurements are approximate and must be verified by the Tenant.

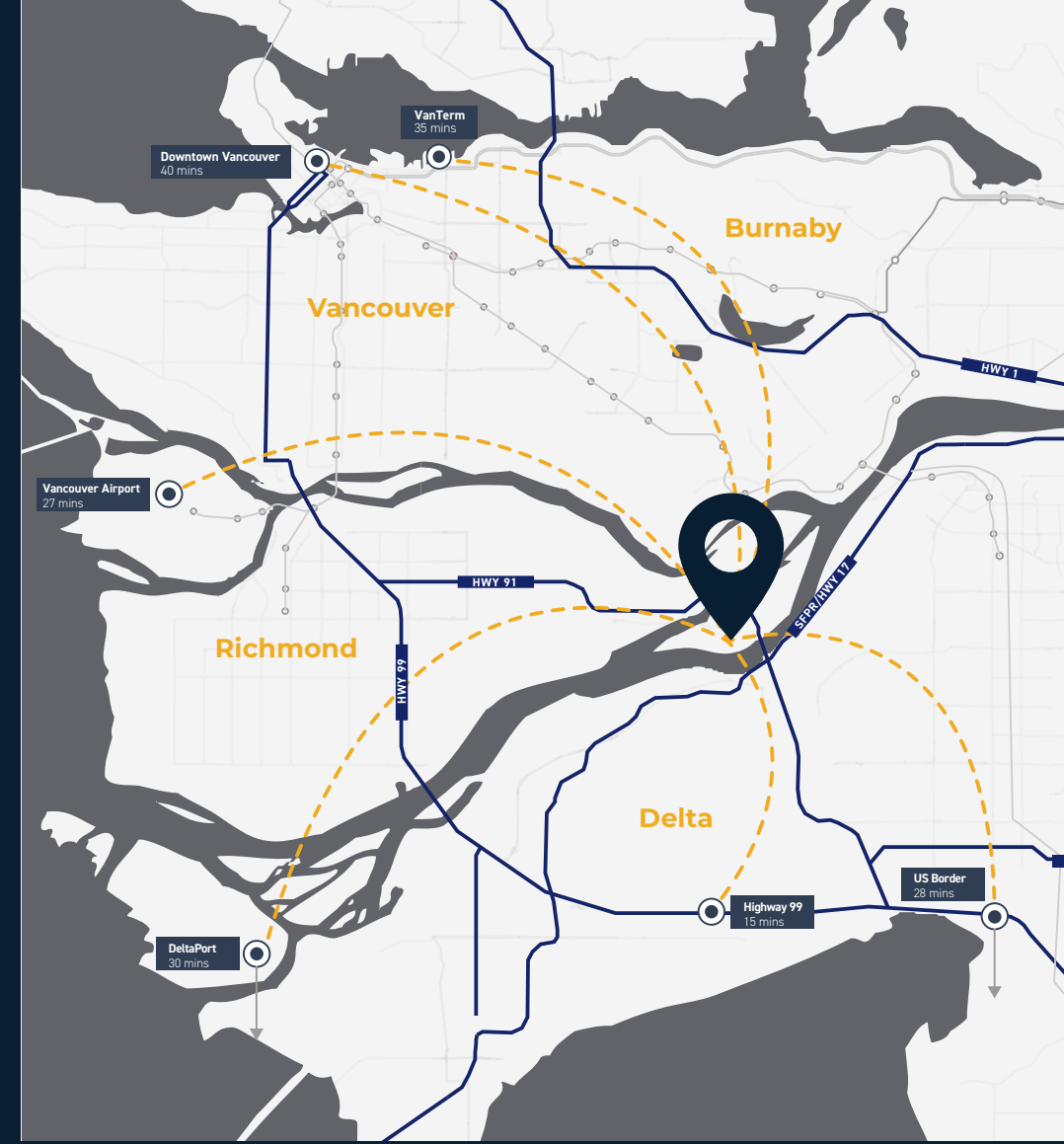

## Location

The property offers excellent access being strategically located in Annacis Business Park. Located in the centre of the Lower Mainland, Annacis Island is considered a premier distribution centre due to its location and accessibility to all municipalities. Highway 91 and Highway 99 provide easy access to all Greater Vancouver regions and southwards to the USA.



**Jonathan Jassebi\***  
Vice President  
+1 778 883 8667  
[jonathan.jassebi@jll.com](mailto:jonathan.jassebi@jll.com)



**Mike Thompson\***  
Executive Vice President  
+1 604 998 6036  
[mike.thompson@jll.com](mailto:mike.thompson@jll.com)

[jll.com](http://jll.com)  
510 West Georgia Street, Suite 2150  
Vancouver, BC V6B 0M3  
Jones Lang LaSalle Real Estate Services, Inc.



\*Personal Real Estate Corporation

© 2026 Jones Lang LaSalle Real Estate Services, Inc. All rights reserved. Information set out herein (the "Information") has not been verified by Jones Lang LaSalle Real Estate Services, Inc., Brokerage and any and all of its real estate agents/staff, and to all other divisions of the company (collectively "JLL"). JLL does not represent, warrant or guarantee the accuracy, correctness and completeness of the Information. Given the limitations of the investigations, inquiries and verification that JLL have undertaken, the reliability of this Information must be treated with a suitable degree of caution and neither JLL or any of their affiliates accept any liability or responsibility for the accuracy or completeness of the information contained herein and no reliance should be placed on the information contained in this document. JLL does not accept or assume any responsibility or liability, direct or consequential, for the Information or the recipient's reliance upon the Information. The recipient of the Information should take such steps as the recipient may deem necessary to verify the Information prior to placing any reliance upon the Information. The Information may change and any property described in the Information may be withdrawn from the market at any time without notice or obligation to the recipient from JLL.



**CLICK/SCAN TO**  
**View Team Listings**