

FOR SUBLEASE



**13480  
CRESTWOOD PLACE**

RICHMOND, BC



1,556 SF to 12,090 SF private and open office areas available



**OPPORTUNITY**

Up to 12,090 SF flex office space benefits from over 587 ft. of frontage facing Knight Street, one of the busiest roads connecting Richmond and Vancouver. The office space is complemented by ample glazing throughout the building and provides a modern corporate appeal.

**BUILDING SPECIFICATIONS**

**OFFICE**

- Mix of private offices and open office space
- Floor to ceiling glazing allowing ample natural light
- 587 ft. of frontage on Knight Street
- Upgraded with exterior LED fixtures, new exterior paintwork, new roof
- High quality corporate setting
- HVAC



**HIGHLIGHTS**

**SITE SIZE**  
5.43 acres

**AVAILABLE**  
60 days

**TERM**  
Sublease to April, 2030

**ZONING**  
IB1 (Industrial Business Park)  
Allowing a wide range of general and industrial office uses.

**BASIC RENT**  
\$14.00 PSF

**OPERATING COSTS**  
\$5.77 PSF (2025)  
+ management fee



FLOORPLANS

SITE PLAN

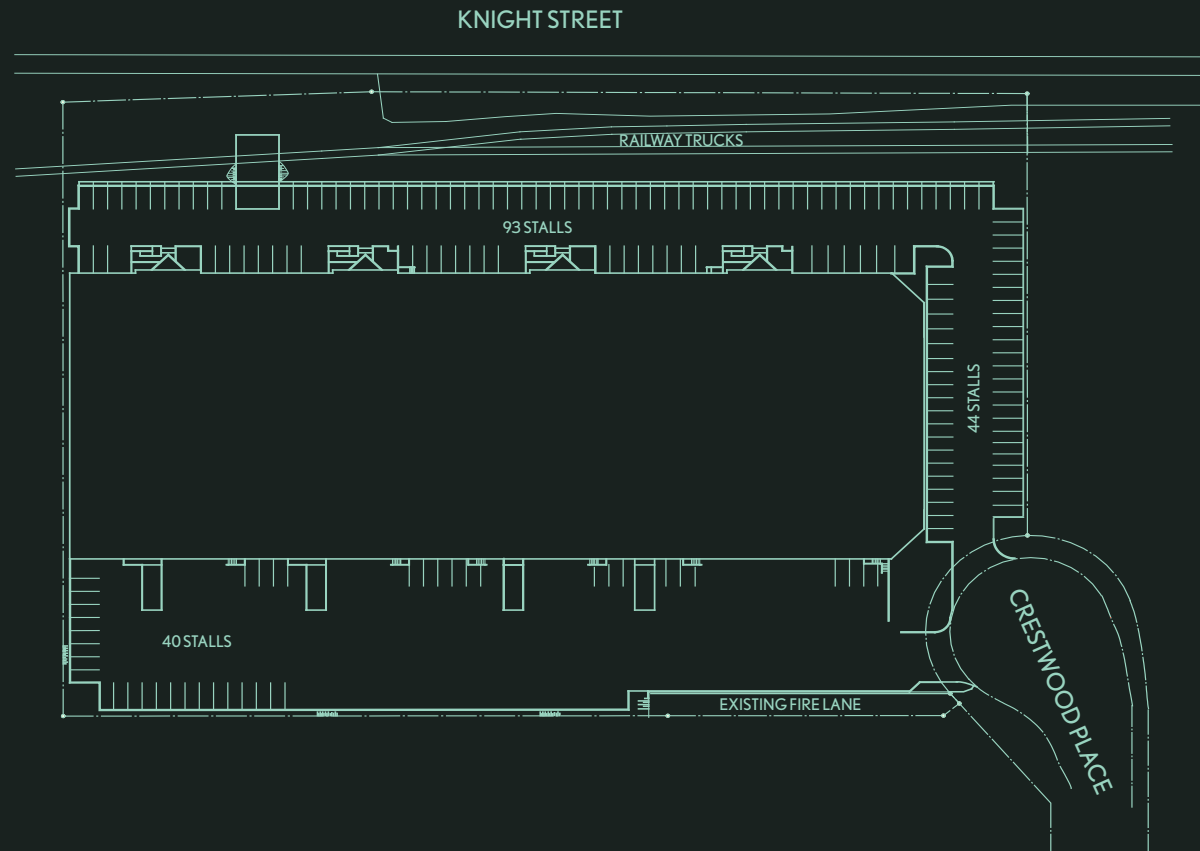

SECOND FLOOR OFFICE



GROUND FLOOR OFFICE/WAREHOUSE

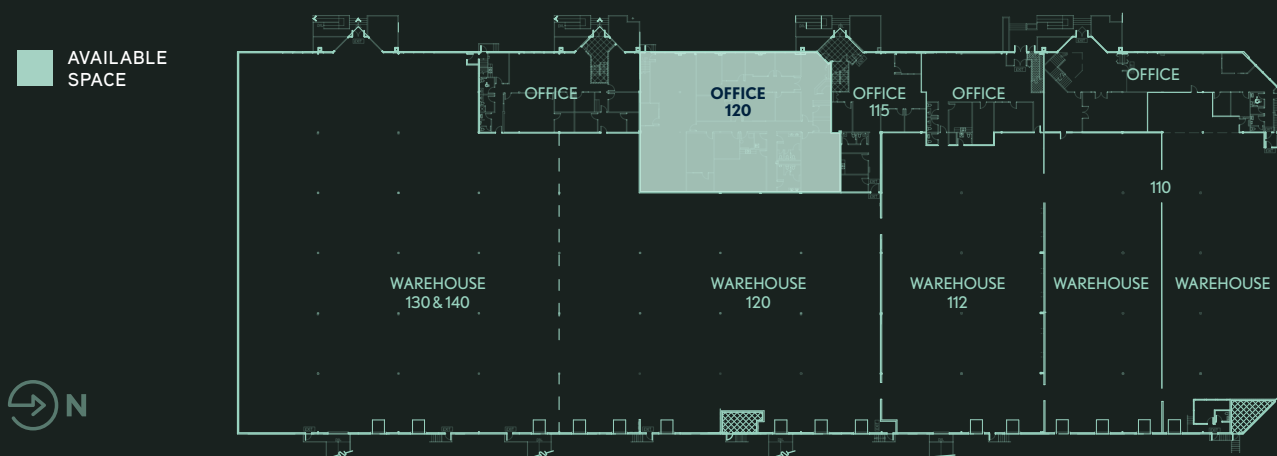

AVAILABILITY FROM 1,556 SF TO 12,090 SF

	Unit	Office (SF)	Warehouse (SF)	Grossed Up Total (SF)
LEASED	110	4,016	18,310	22,391
LEASED	212	4,630	-	4,643
				<b>27,034</b>
LEASED	112	2,384	12,035	14,419
LEASED	210	2,411	-	2,411
				<b>16,830</b>
LEASED	115	2,377	14,220	16,744
	120	6,819	-	6,839
	215	1,552	-	1,556
	225	3,683	-	3,694
				<b>12,090</b>
LEASED	130	3,320	12,000	15,364
LEASED	140	-	22,896	22,962
LEASED	230	3,336	-	3,346
				<b>41,672</b>
	Sprinkler	-	150	GU
	Electrical	-	180	0.29%





**IMMEDIATE**  
Access to Highways  
91 and 99



**12 MIN**  
Richmond Centre



**22 MIN**  
Deltaport container  
terminal



**13 MIN**  
YVR Vancouver International  
Airport / UPS Air Freight



**25 MIN**  
Canada / US border



**30 MIN**  
Downtown Vancouver





## 13480 CRESTWOOD PLACE

### **JONATHAN JASSEBI\***

Vice President

+1 778 883 8667

[jonathan.jassebi@jll.com](mailto:jonathan.jassebi@jll.com)

### **BRUNO FIORVENTO\***

Executive Vice President

+1 604 551 1863

[bruno.fiorvento@jll.com](mailto:bruno.fiorvento@jll.com)

\*Personal Real Estate Corporation

© 2025 Jones Lang LaSalle Real Estate Services, Inc. All rights reserved. Information set out herein (the "Information") has not been verified by Jones Lang LaSalle Real Estate Services, Inc., Brokerage and any and all of its real estate agents/staff, and to all other divisions of the company (collectively "JLL"). JLL does not represent, warrant or guarantee the accuracy, correctness and completeness of the Information. Given the limitations of the investigations, inquiries and verification that JLL have undertaken, the reliability of this Information must be treated with a suitable degree of caution and neither JLL or any of their affiliates accept any liability or responsibility for the accuracy or completeness of the information contained herein and no reliance should be placed on the information contained in this document. JLL does not accept or assume any responsibility or liability, direct or consequential, for the Information or the recipient's reliance upon the Information. The recipient of the Information should take such steps as the recipient may deem necessary to verify the Information prior to placing any reliance upon the Information. The Information may change and any property described in the Information may be withdrawn from the market at any time without notice or obligation to the recipient from JLL.

